

GLYCOLED COOL / HOT WATER FAN COILS

FAN COIL PROFESSIONALI

Il Fan Coil è un'unità di trattamento dell'aria potente ed affidabile con una portata d'aria massima di 8.000 m³/h. L'unità si connette velocemente ad un chiller o ad un circuito di acqua refrigerata attraverso un collegamento camlock.

- L'unità è dotata di attacchi idraulici a sgancio rapido - Motore del ventilatore silenzioso
- Bel design
- Griglia di scarico aria regolabile
- Controllo elettronico
- Connessione standard monofase
- Valvola motorizzata a 3 vie
- Termostato automatico
- Controllo remoto

SPECIFICHE TECNICHE

		FAN COIL 20 - 40	FAN COIL 32 - 50	FAN COIL 50 - 70
CAPACITA' DI RAFFREDDAMENTO/RISALDAMENTO				
Capacità di raffreddamento (water 7/12°C, 27°C / 60%)	kW	20	32	50
Capacità di riscaldamento (water 80/70°C), 10°C/50% ambiente)	kW	40	50	125
OPERATING LIMITS				
Range temperatura di lavoro	°C	10 / 50	10 / 50	10 / 50
Range Temperatura Acqua su batteria	°C	5/ 80	5/ 80	5/ 80
Perdita di pressione del fluido	kPa	38	42	48
Max. Pressione di esercizio	Bar	6	6	6
Collegamento scarico condensa	Hose tail	3/4"	3/4"	3/4"
Accoppiamento fluido	Camlock	1"	32 mm / 1 1/4" camlock	32 mm / 1 1/4" camlock
DATI ELETTRICI				
Alimentazione elettrica	V	230/1/50 Hz	230/1/50 Hz	230/1/50 Hz
Massima Potenza Assorbita	kW	0,5	1.7	3.2
Massima Corrente Assorbita	A	1,6	3.3	5.2
Corrente L.R.A	A	11	12	14
PORTATA D'ARIA				
Portata d'aria	m ³ /h	1600-1990-2100	2600-2700-3600	5000 -6000-8000
Massimo Lancio	Pa	80	190	210 -200-150
	m	10/12/18	10/12/18	10/12/18
RUMOROSITA'				
Livello di pressione Sonora (a 3 metri in campo libero) dB(A)		53	53	58
DATI DIMENSIONALE				
Profondità	mm	520	590	790.5
Larghezza	mm	720	720	1508
Altezza	mm	1650	1850	1864
Weight	mm	101	129	129

TURNING THE COVER THE AIR DELIVERY DIRECTION CAN BE CHANGED

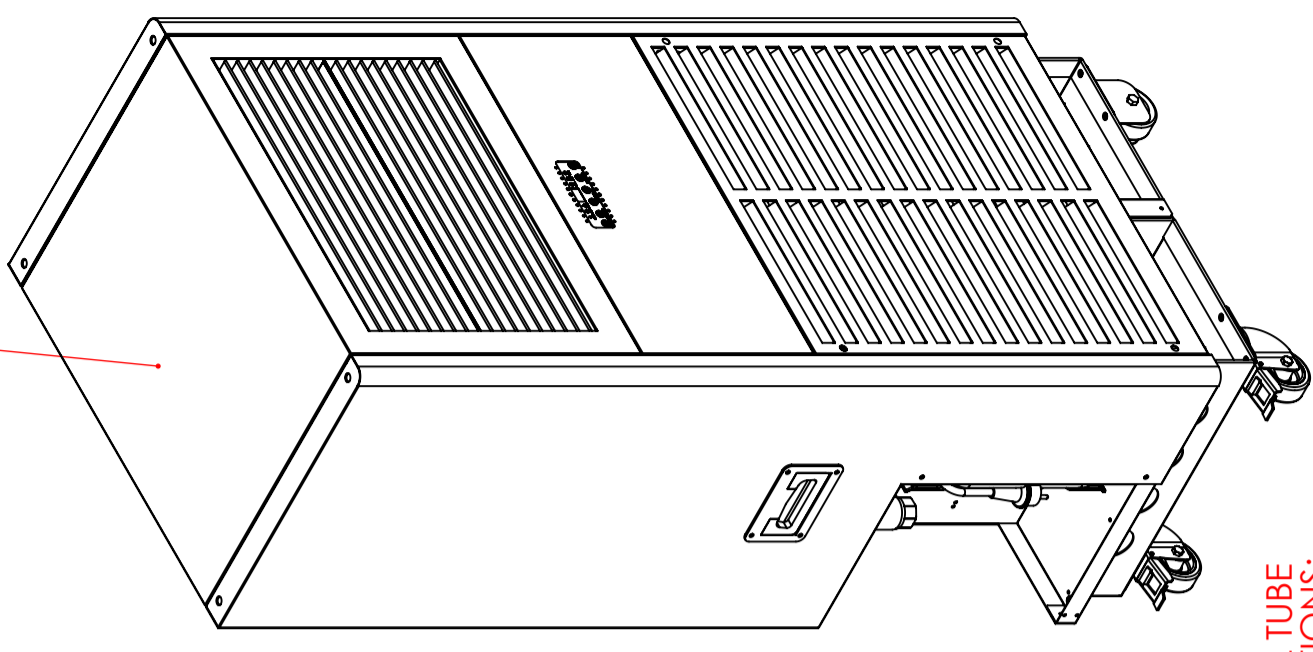

OPTIONAL TUBE CONNECTIONS:
-QUICK (GEKA)
-CAM-LOCK

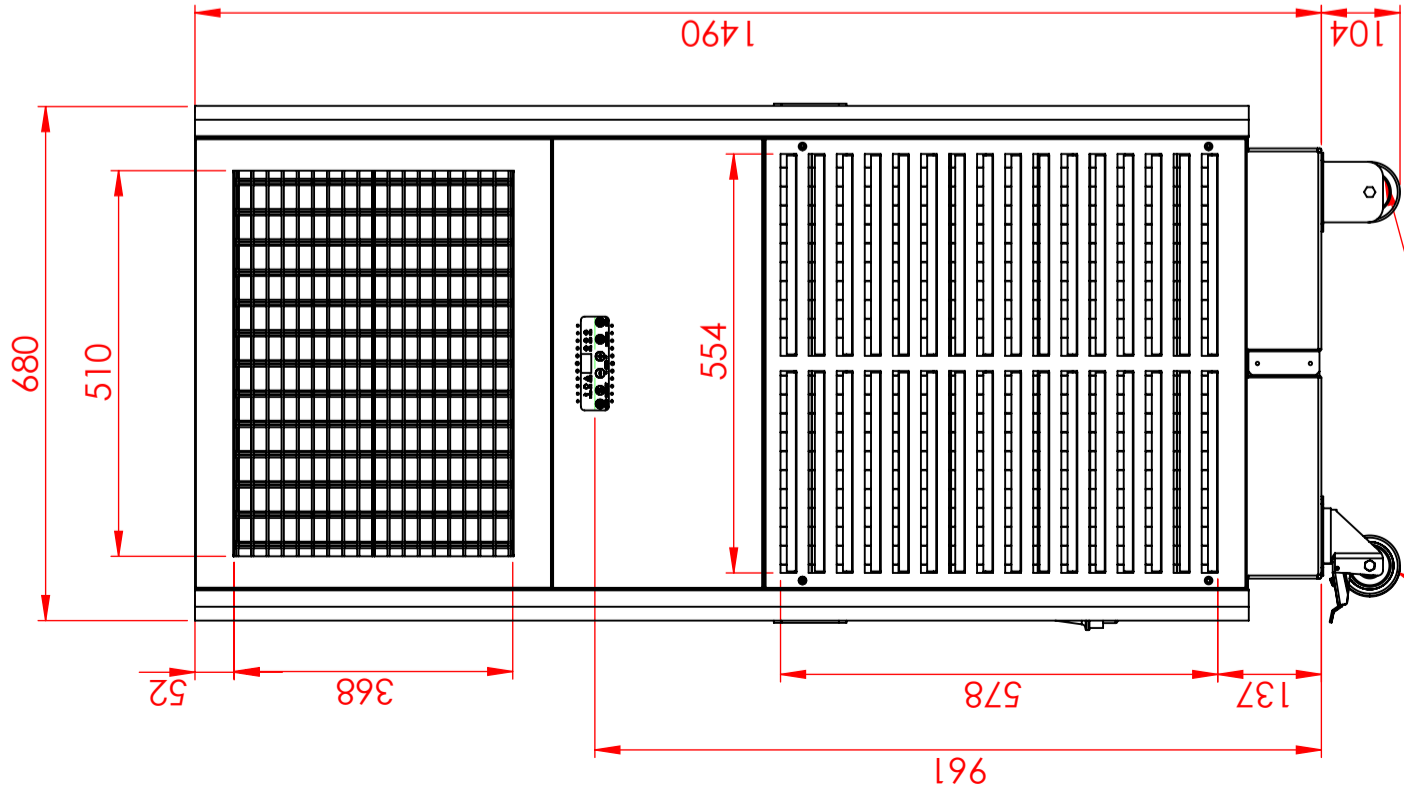
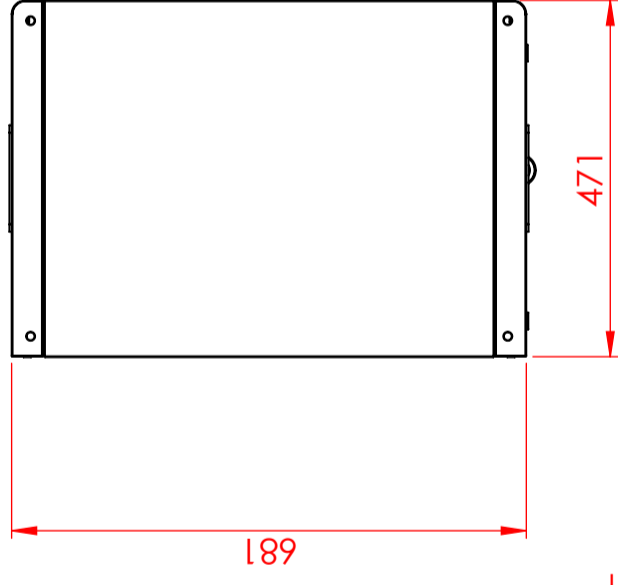
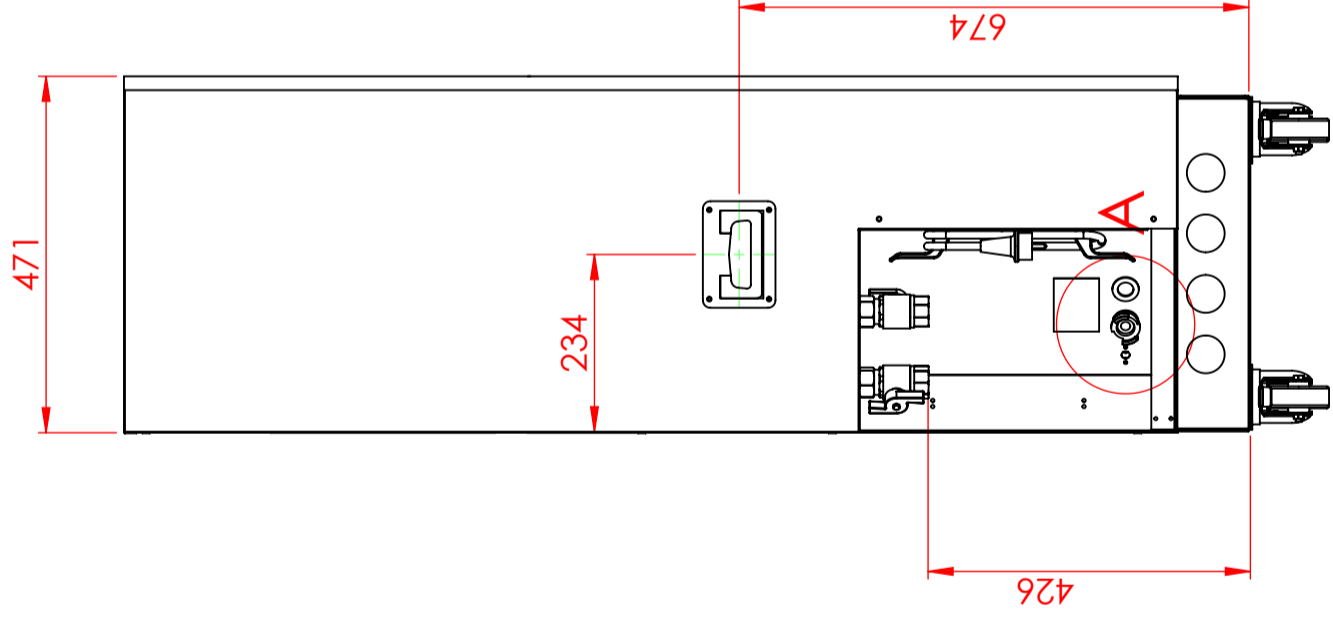
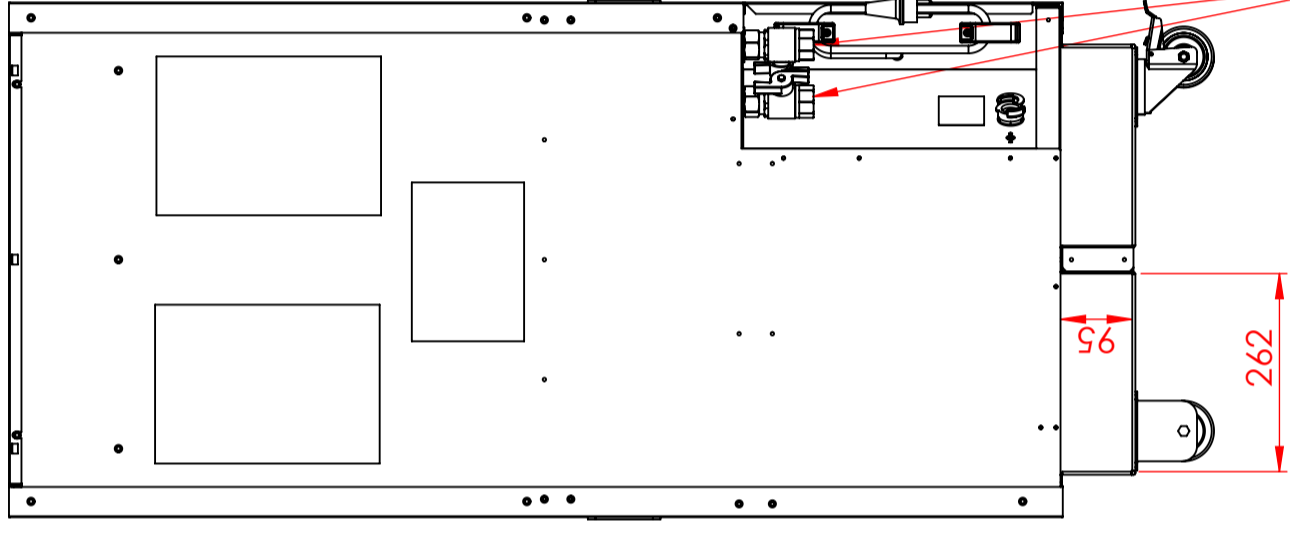

WHEELS OPTIONAL

DETTAGLIO A

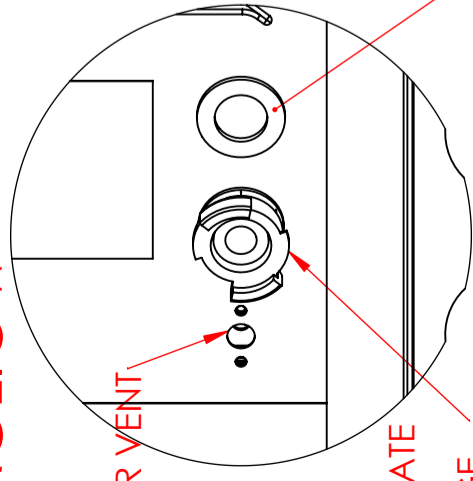

COIL AIR VENT

CONDENSATE WATER DISCHARGE

OVERFULL DISCHARGE

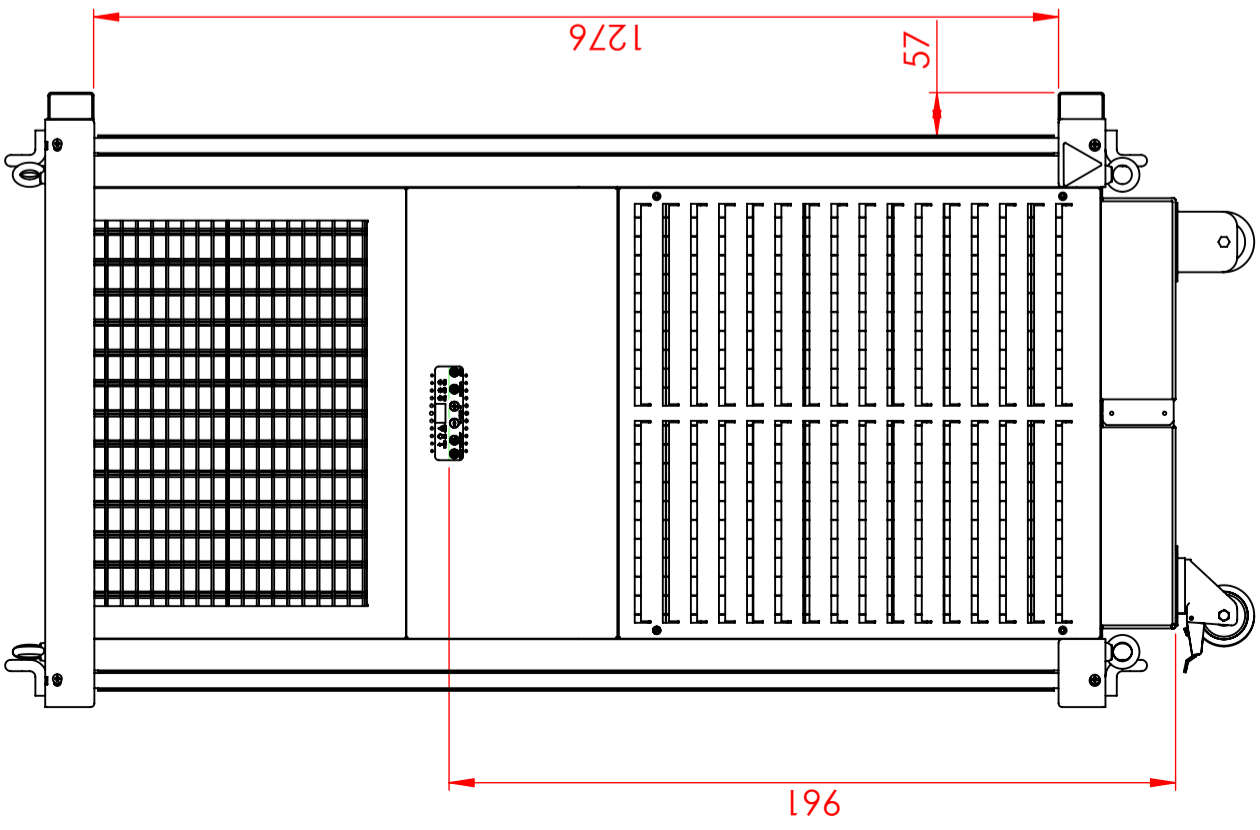
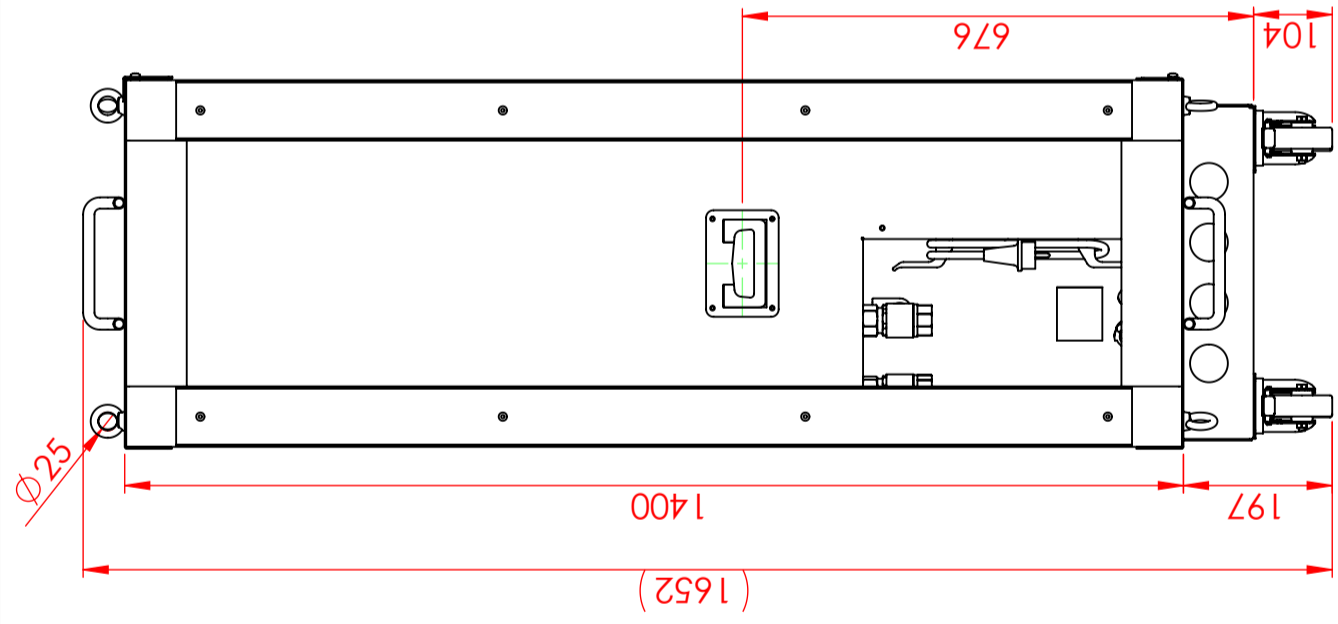
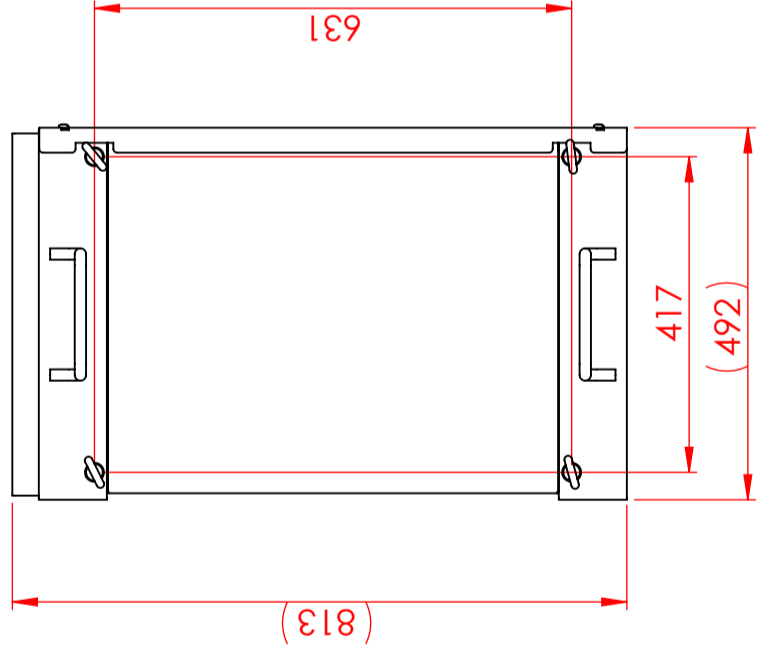
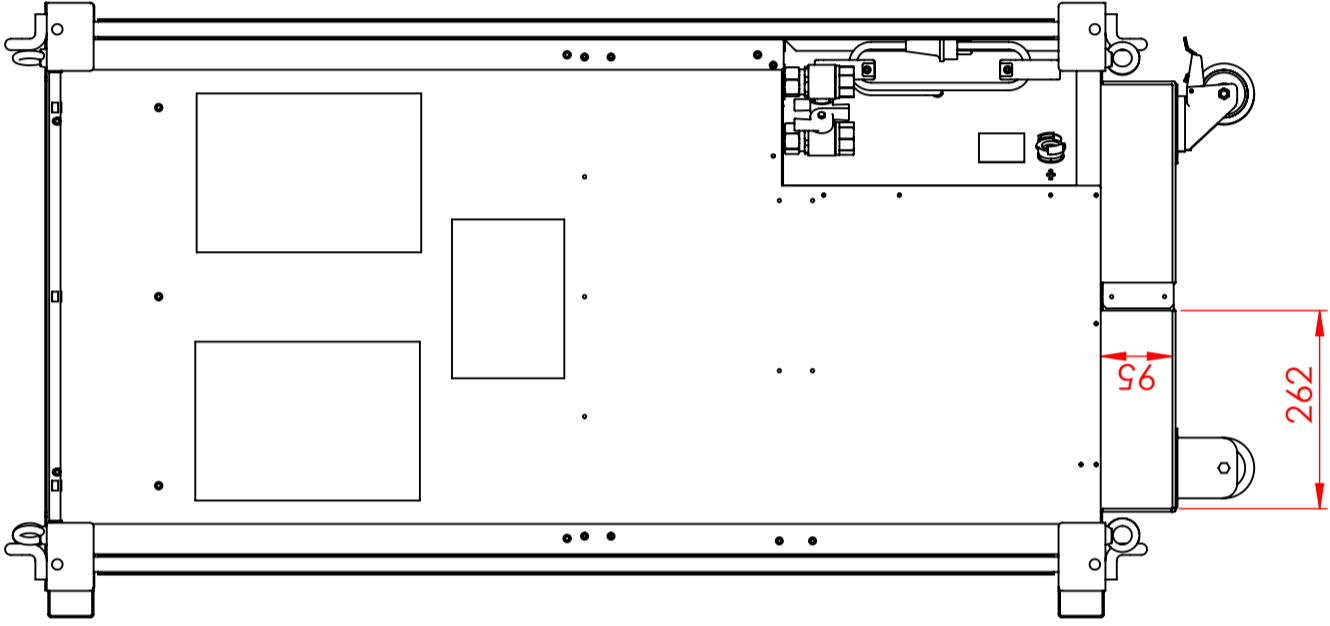
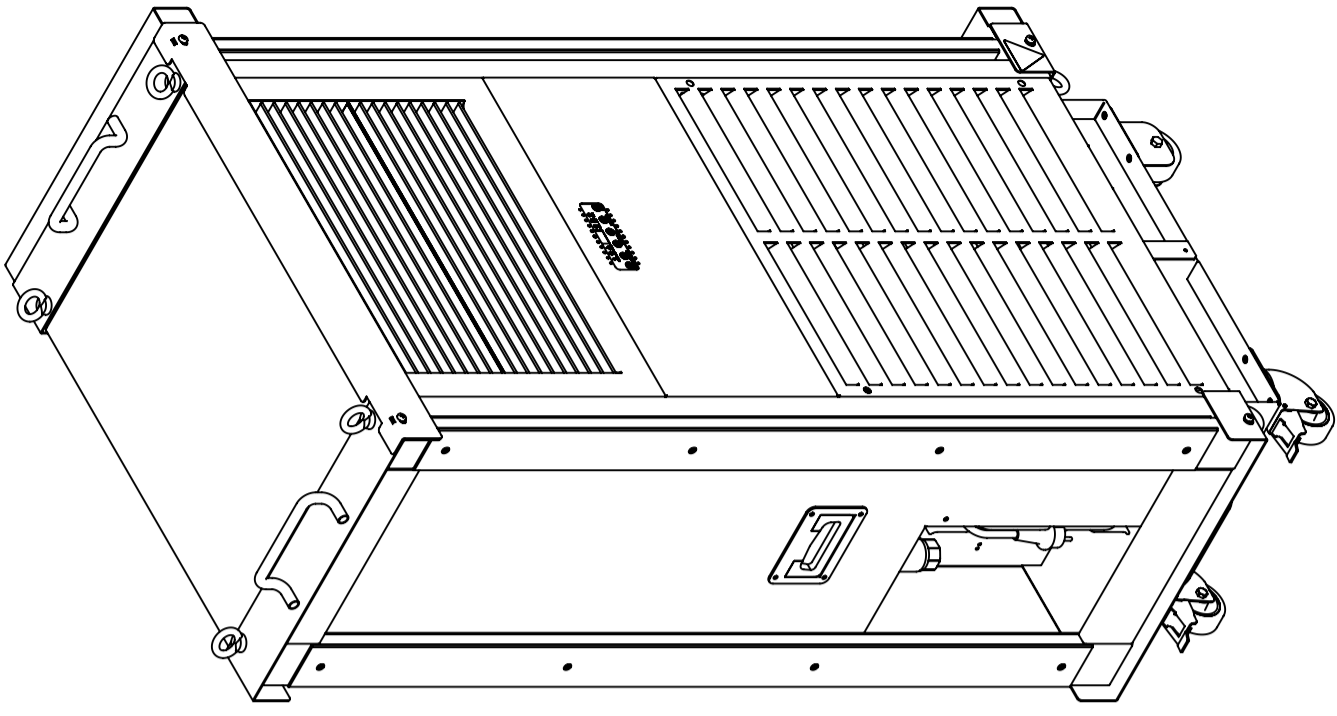

TURNING THE COVER THE AIR DELIVERY DIRECTION CAN BE CHANGED

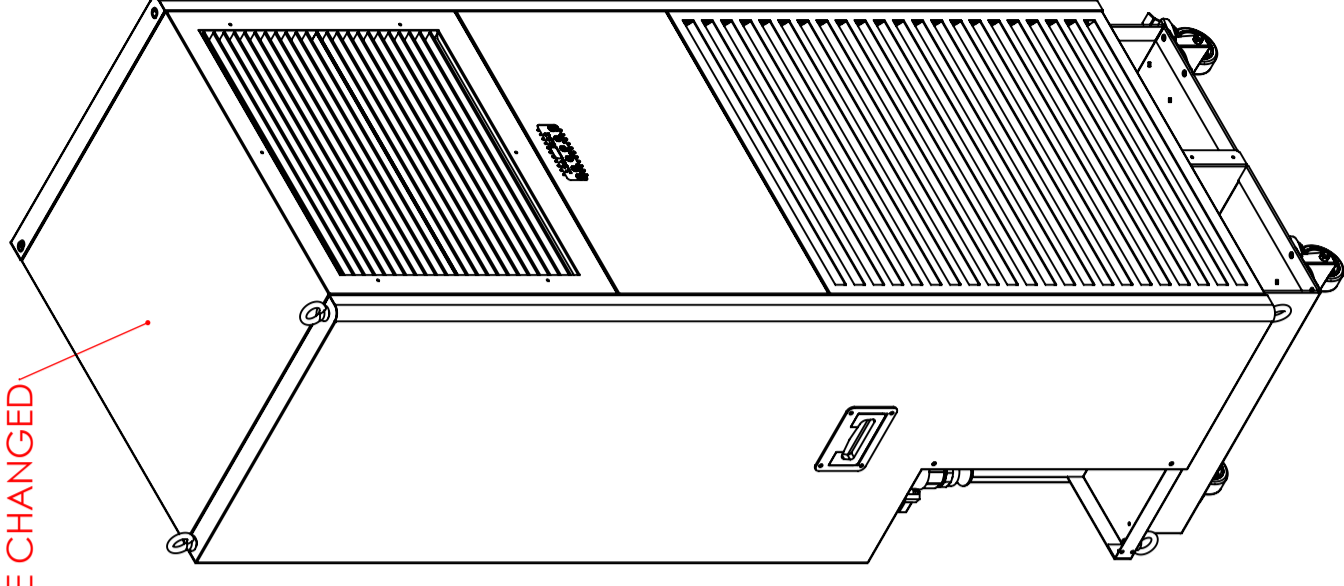

OPTIONAL TUBE CONNECTIONS:
-QUICK (GEKA)
-CAM-LOCK

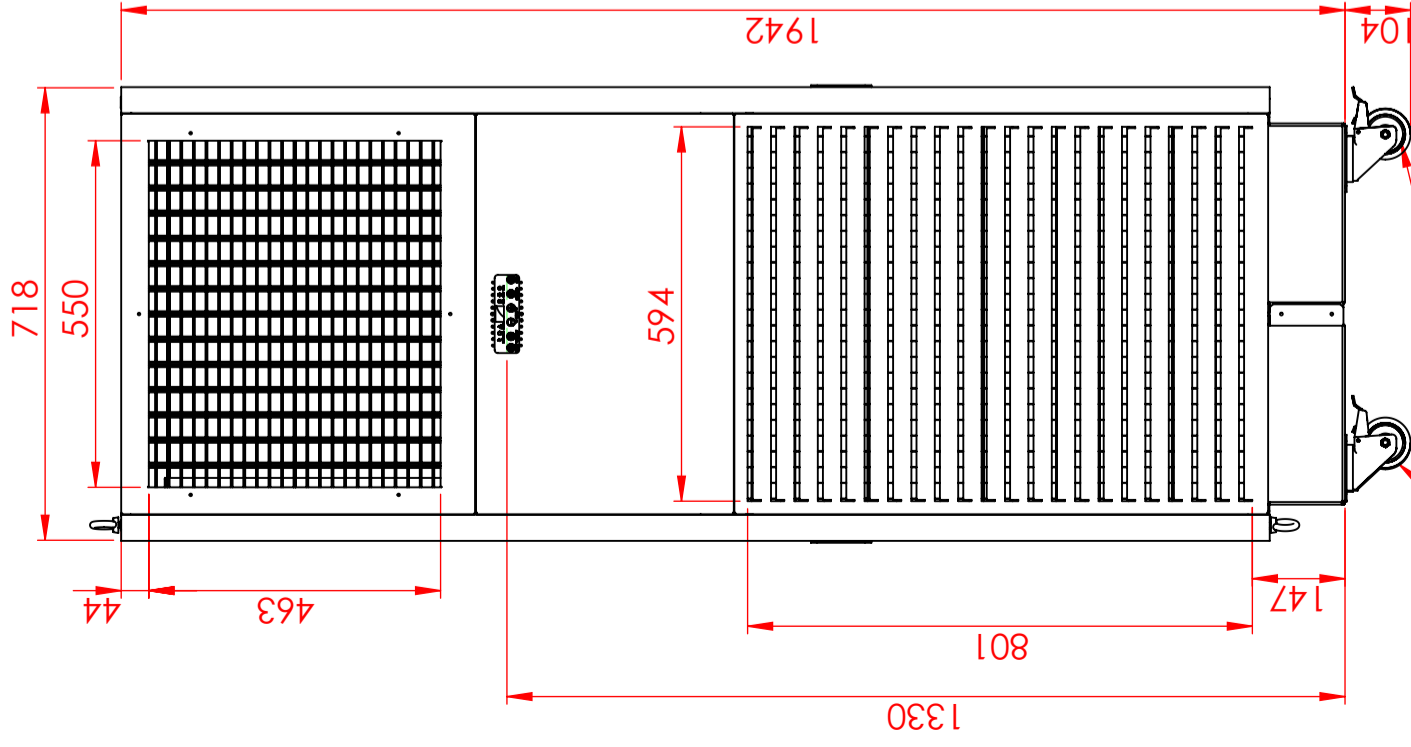
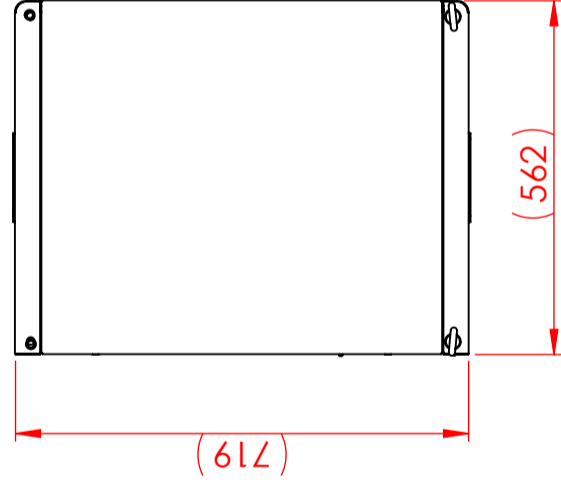
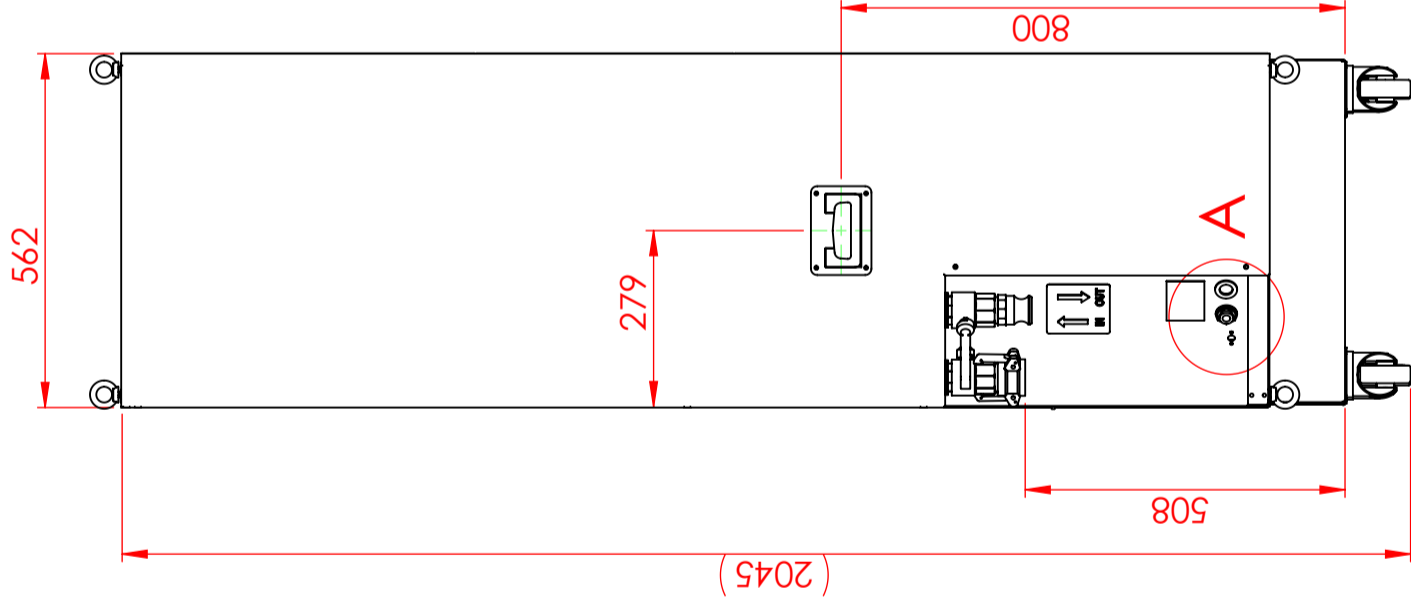
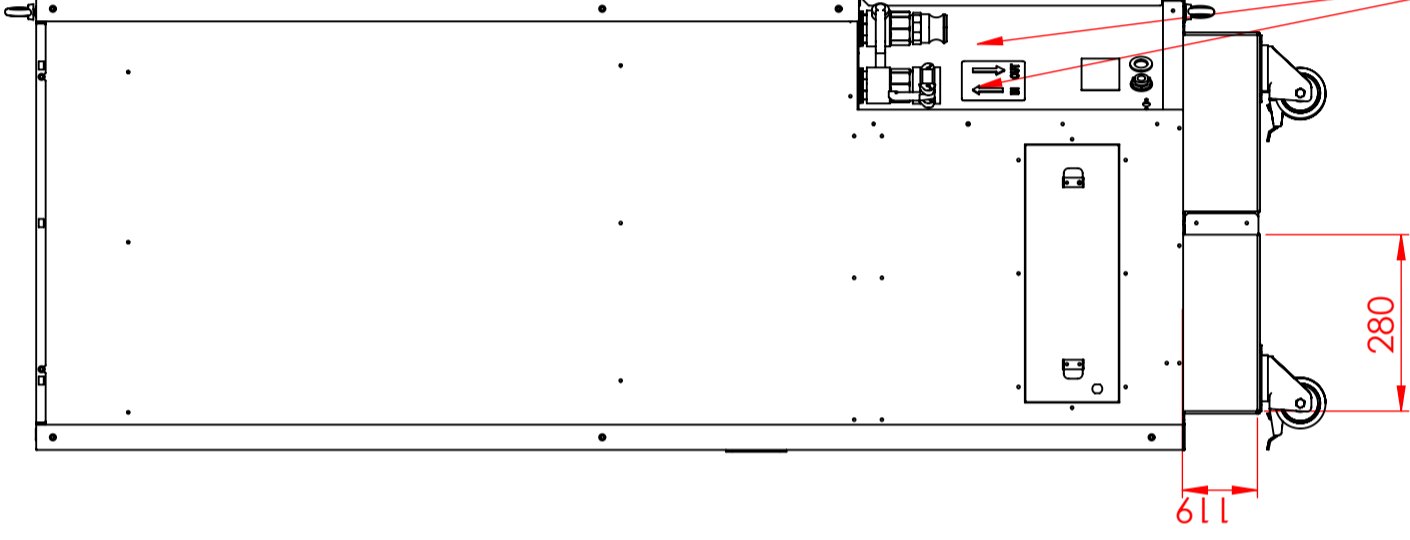

WHEELS
OPTIONAL

DETTAGLIO A

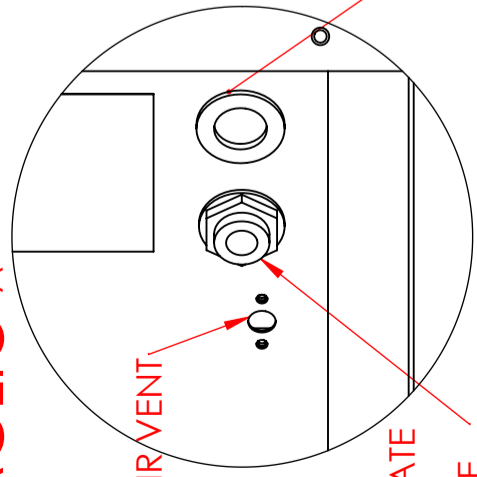

COIL AIR VENT

CONDENSATE
WATER
DISCHARGE

OVERFULL
DISCHARGE

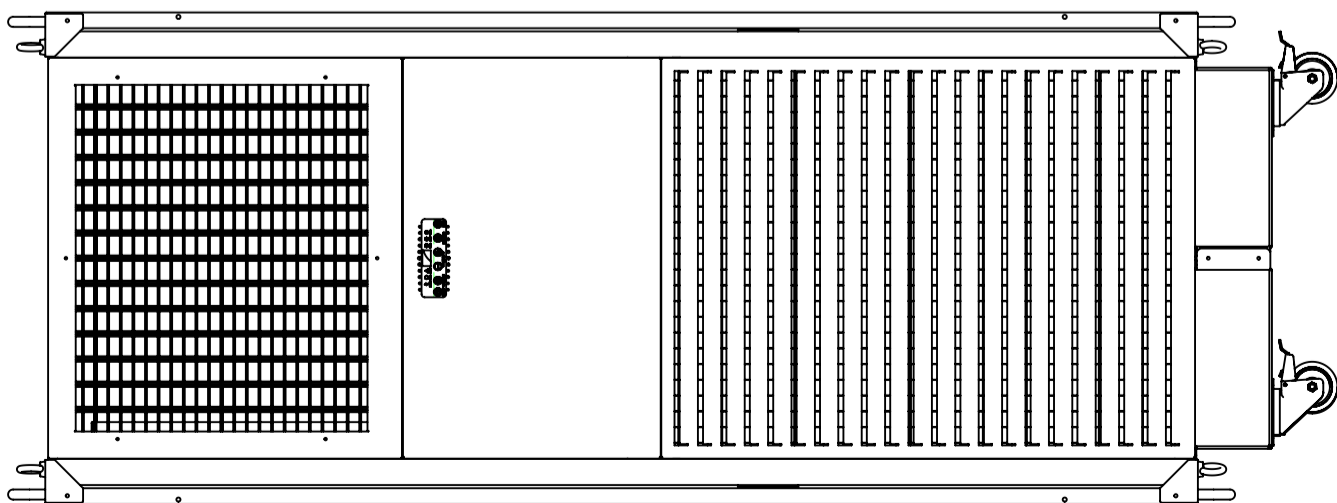
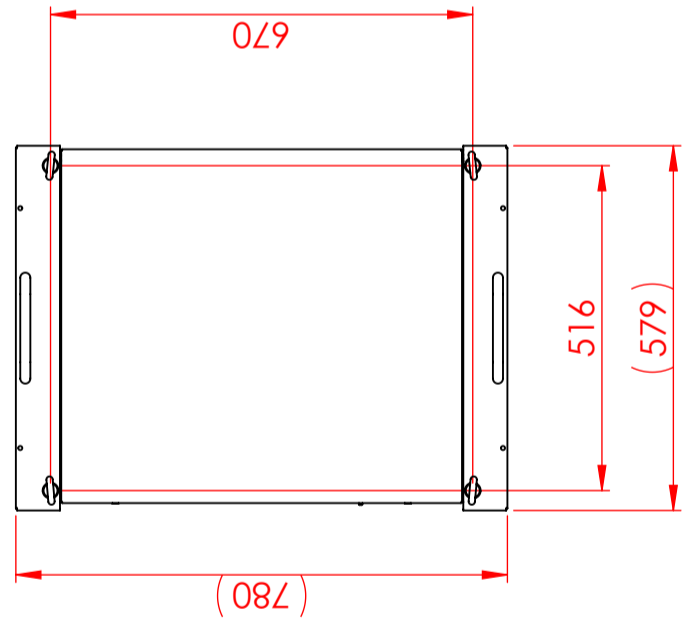
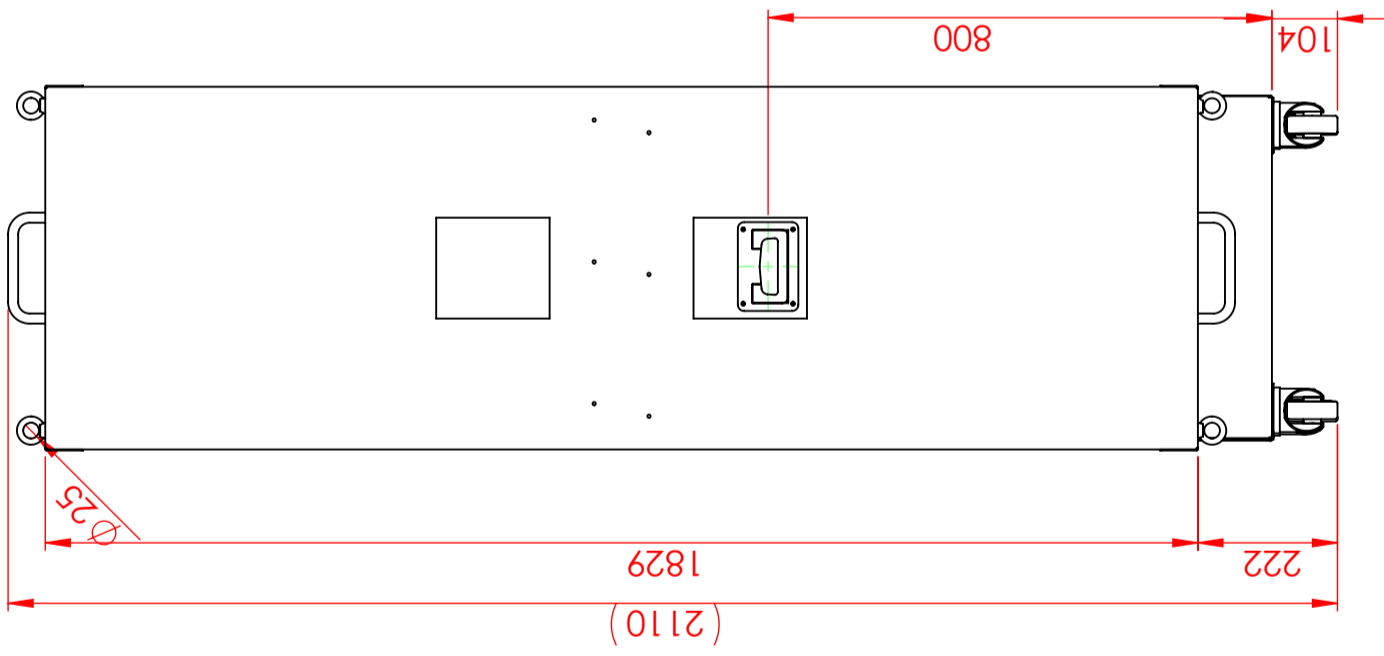
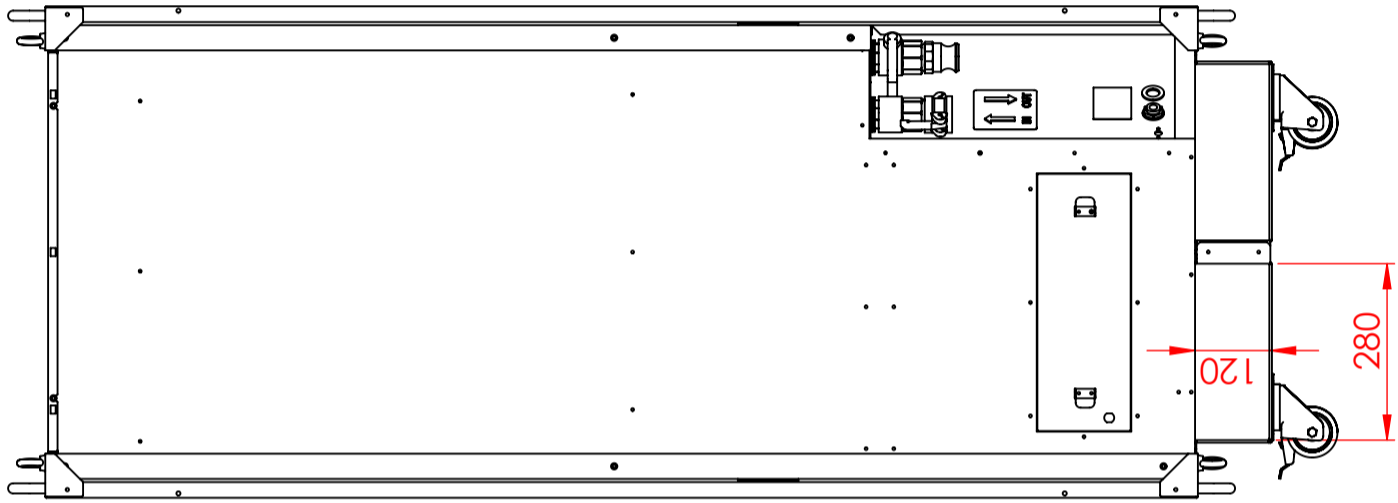
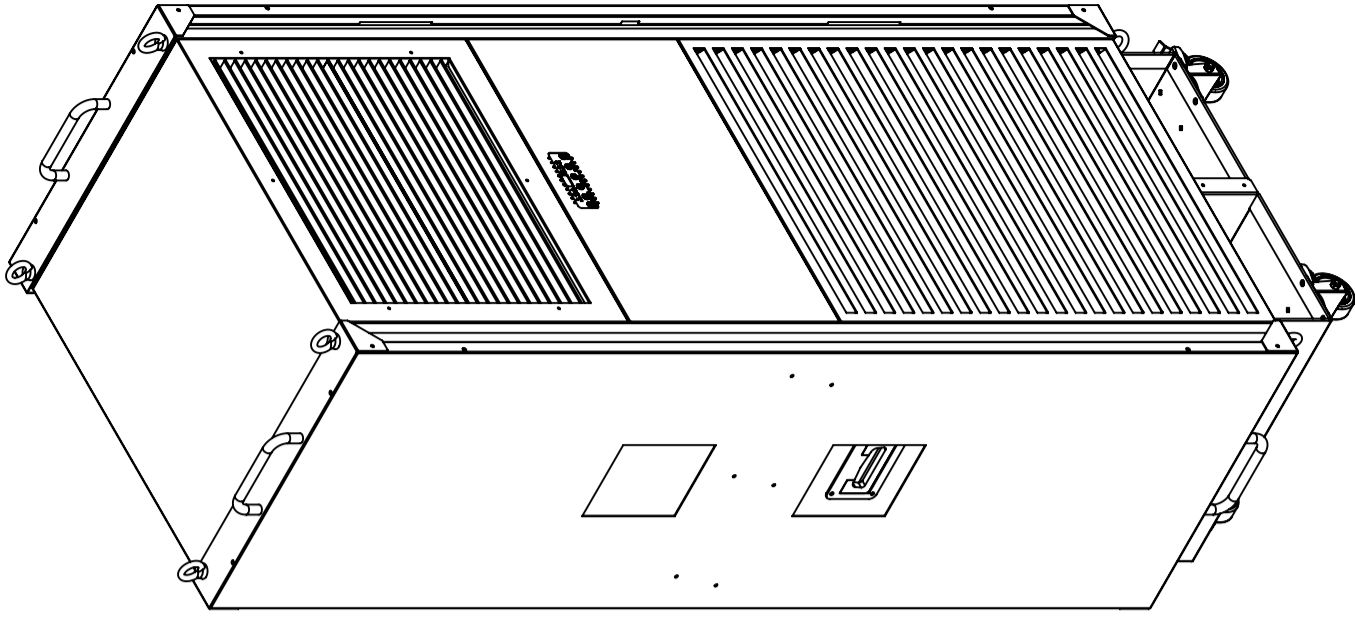

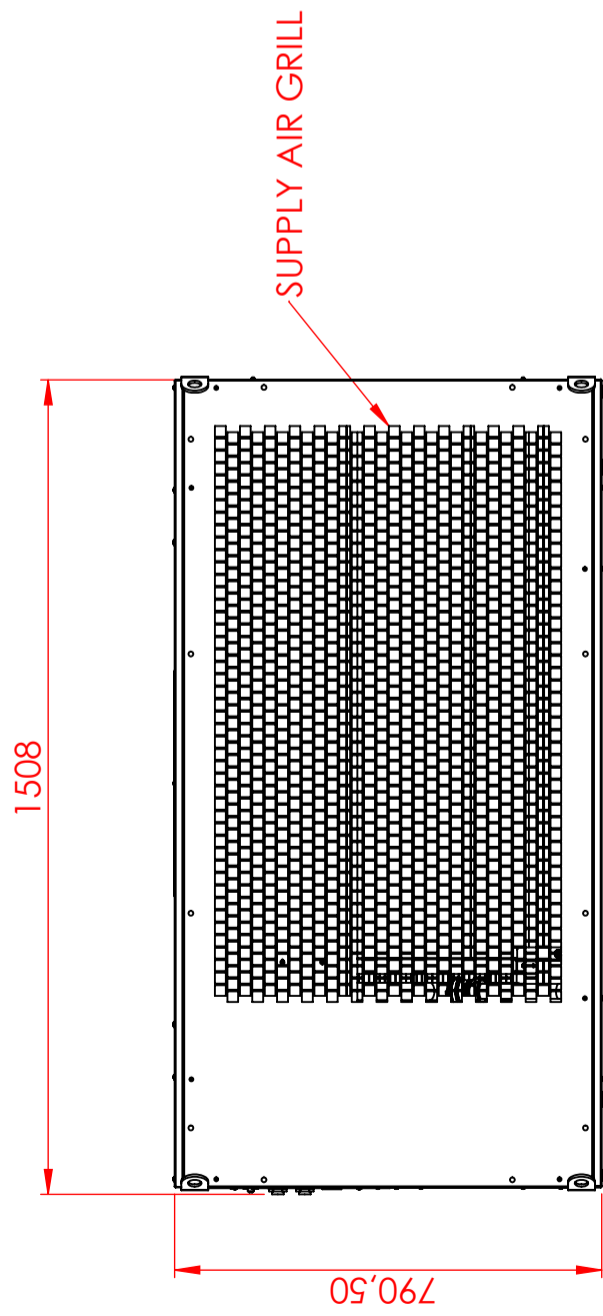
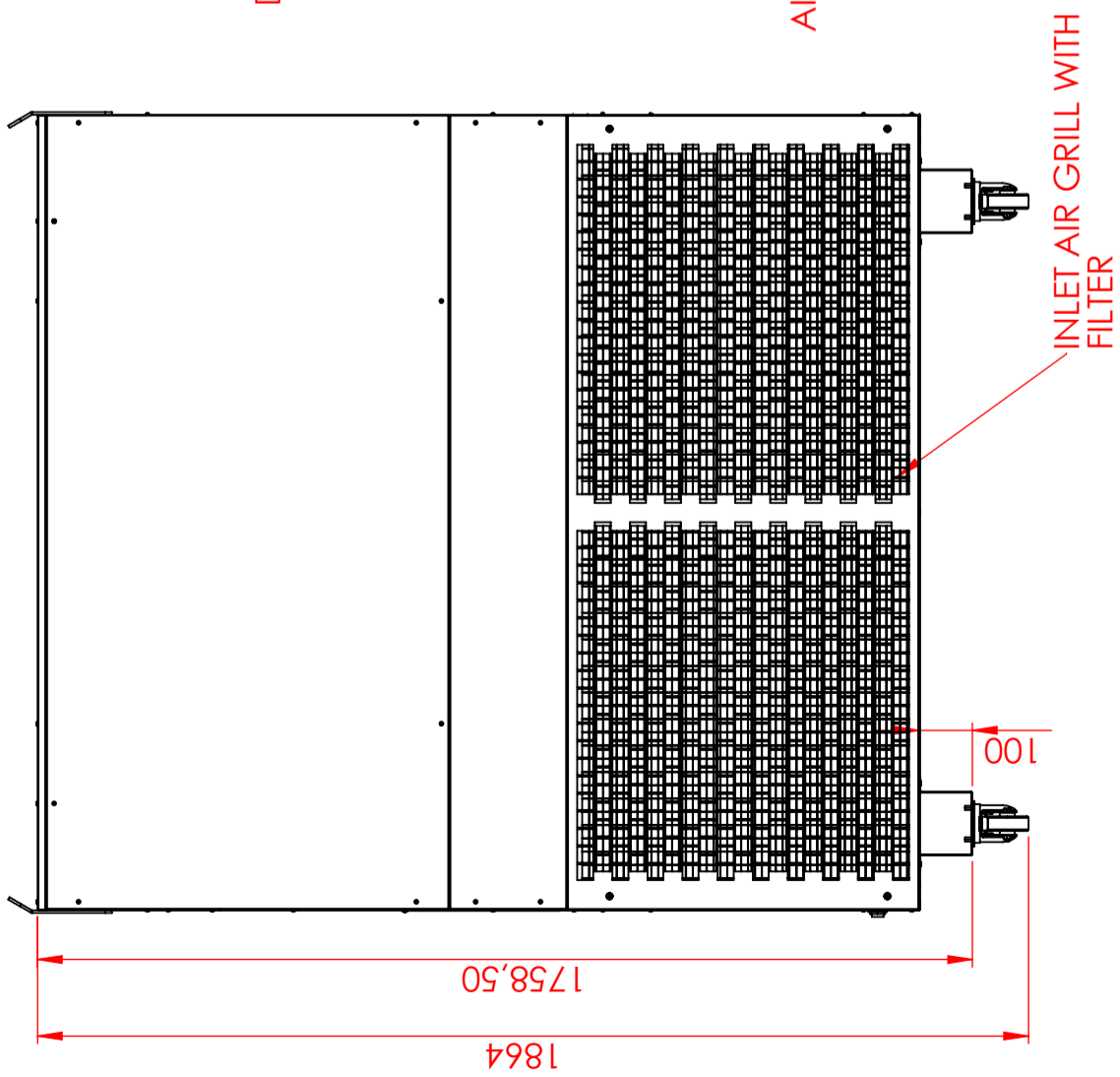
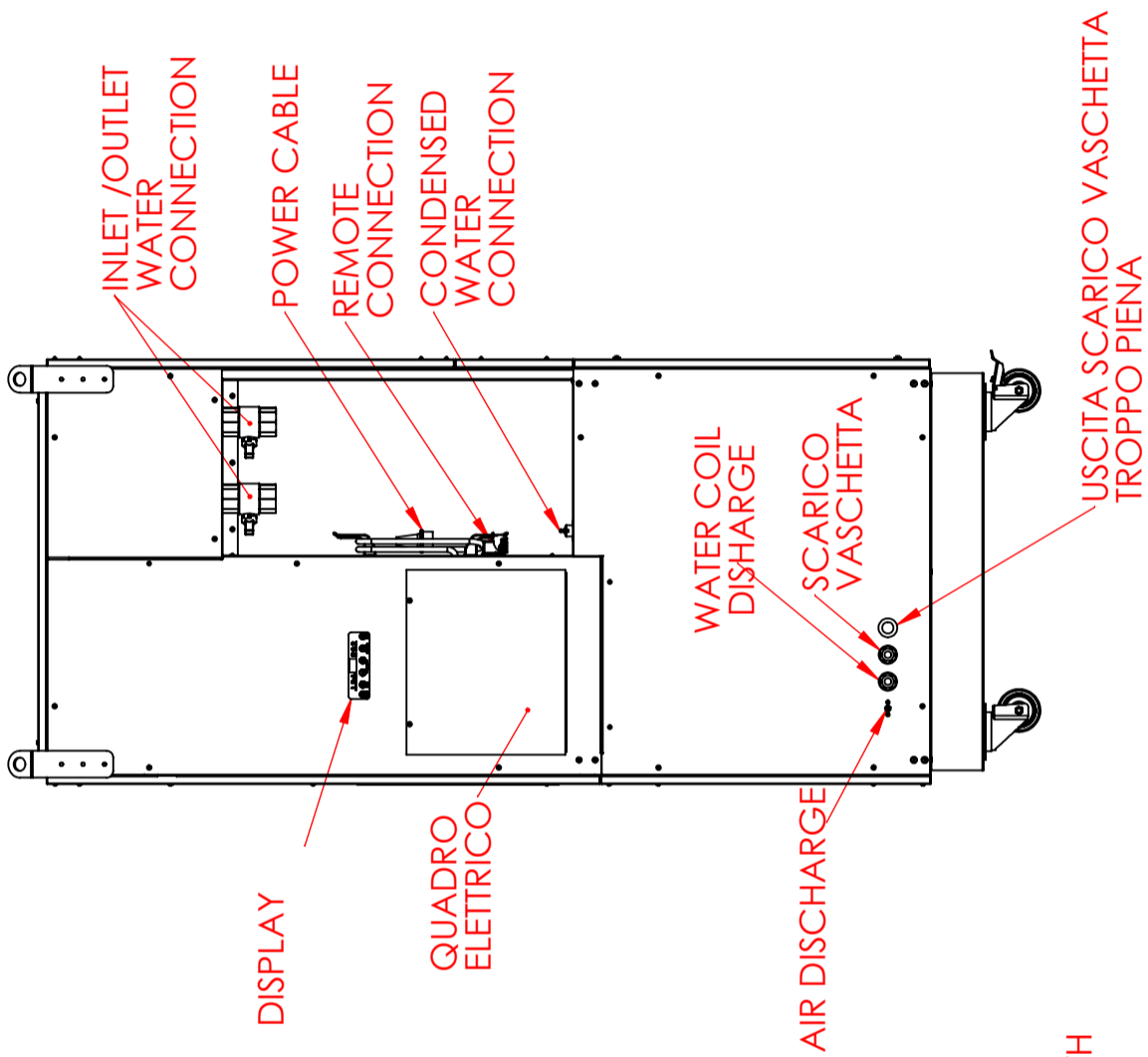
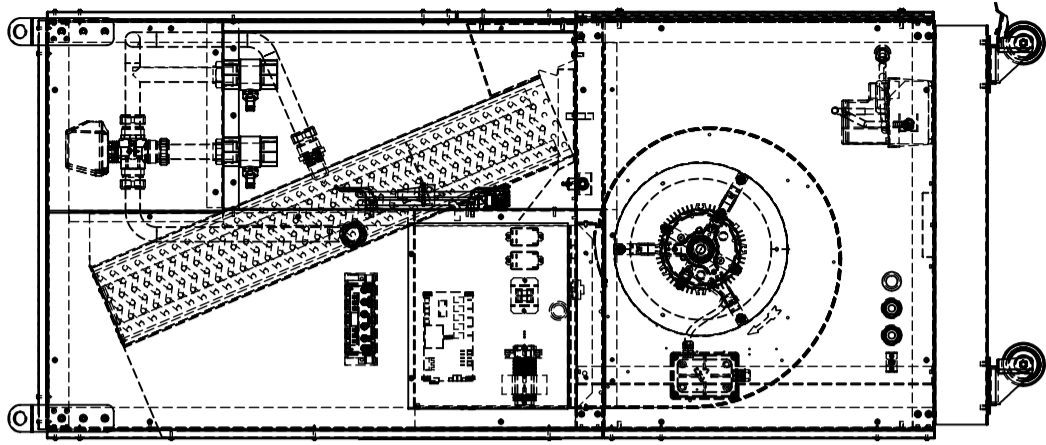

FFCV50 WITH 360° AIR SUPPLY PLENUM

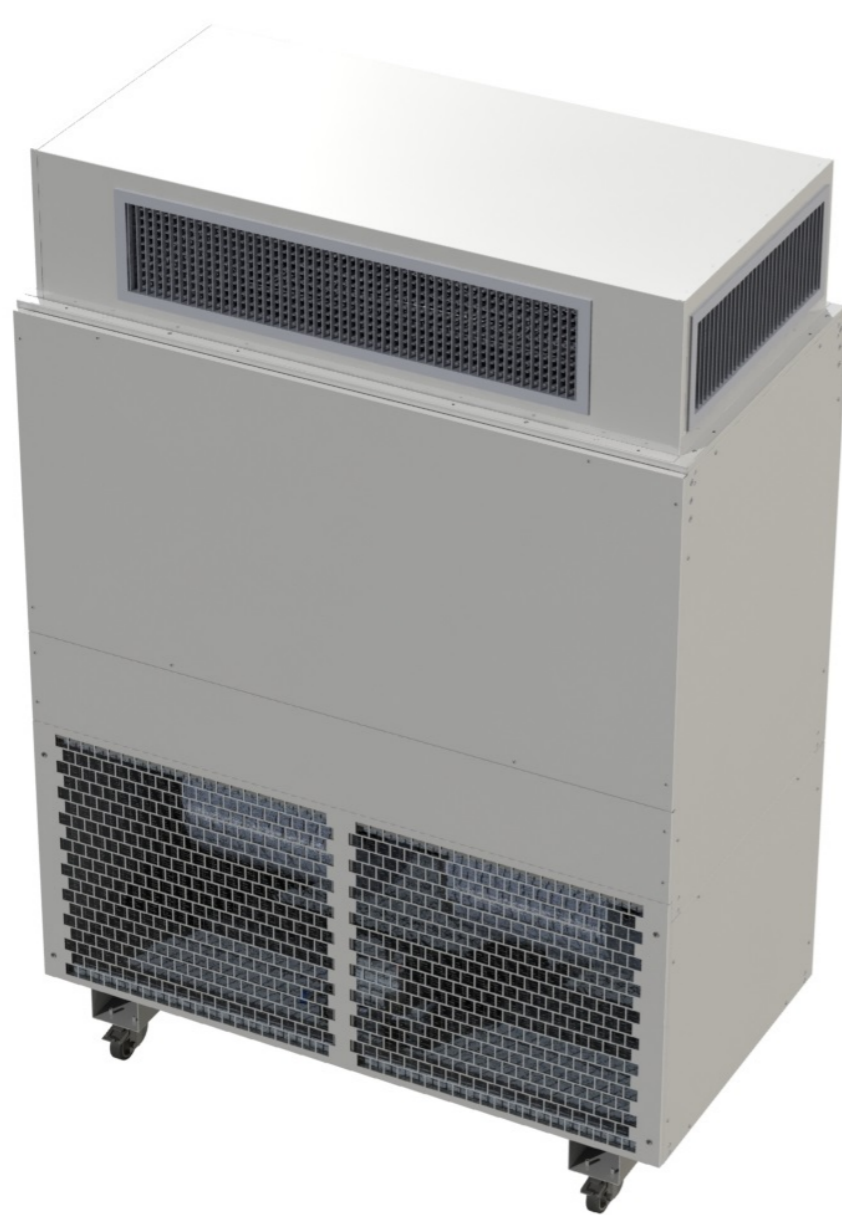

SPECIAL FRAME KIT FOR STORING THE UNITS FFCV21-FFCV32



COOLING AND HEATING CAPACITY 32 kW

COOLING CAPACITY			
AIR FLOW		3600 (m ³ /h) (max fan speed)	2600 (m ³ /h) (Low fan speed)
WATER : Inlet Temp 6°C Outlet Temp 11°C	Ambient temperature 27°C / 60%	34 kW	26,5 kW
WATER : Inlet Temp 7°C Outlet Temp 12°C	Ambient temperature 27°C / 60%	31,5 kW	24,5 kW
WATER : Inlet Temp 7°C Outlet Temp 12°C	Ambient temperature 28°C / 60%	34,5 kW	27 kW
WATER : Inlet Temp 7°C Outlet Temp 12°C	Ambient temperature 26°C / 60%	28,5 kW	22,5 kW
WATER : Inlet Temp 7°C Outlet Temp 12°C	Ambient temperature 25°C / 60%	26 kW	20,5 kW

HEATING CAPACITY			
AIR FLOW		3600 (m ³ /h) (max fan speed)	2600 (m ³ /h) (Low fan speed)
WATER : Inlet Temp 80°C Outlet Temp 70°C	Ambient temperature 20°C / 55%	63 kW	47,5 kW
WATER : Inlet Temp 80°C Outlet Temp 70°C	Ambient temperature 18°C / 55%	65 kW	40,5 kW
WATER : Inlet Temp 70°C Outlet Temp 60°C	Ambient temperature 20°C / 55%	51 kW	39 kW
WATER : Inlet Temp 70°C Outlet Temp 60°C	Ambient temperature 18°C / 55%	54 kW	40,5 kW

COOLING AND HEATING CAPACITY 21 kW

COOLING CAPACITY			
AIR FLOW		2400 (m ³ /h) (max fan speed)	1800 (m ³ /h) (Low fan speed)
WATER : Inlet Temp 6°C Outlet Temp 11°C	Ambient temperature 27°C / 60%	22,5 kW	17,5 kW
WATER : Inlet Temp 7°C Outlet Temp 12°C	Ambient temperature 27°C / 60%	21 kW	16 kW
WATER : Inlet Temp 7°C Outlet Temp 12°C	Ambient temperature 28°C / 60%	23 kW	18 kW
WATER : Inlet Temp 7°C Outlet Temp 12°C	Ambient temperature 26°C / 60%	19 kW	15 kW
WATER : Inlet Temp 7°C Outlet Temp 12°C	Ambient temperature 25°C / 60%	17 kW	13,5 kW

HEATING CAPACITY			
AIR FLOW		2400 (m ³ /h) (max fan speed)	1800 (m ³ /h) (Low fan speed)
WATER : Inlet Temp 80°C Outlet Temp 70°C	Ambient temperature 20°C / 55%	41 kW	31 kW
WATER : Inlet Temp 80°C Outlet Temp 70°C	Ambient temperature 18°C / 55%	43 kW	26,5 kW
WATER : Inlet Temp 70°C Outlet Temp 60°C	Ambient temperature 20°C / 55%	33 kW	26 kW
WATER : Inlet Temp 70°C Outlet Temp 60°C	Ambient temperature 18°C / 55%	35,5 kW	27 kW

FAN MOTOR PERFORMANCE 32 kW

FAN MOTOR PERFORMANCE						
AIR FLOW (m ³ /h)		3600	3000	2600	2000	Noise dB(A) at 3 m free field
Pa	Available static pressure MAX fan speed (Pa)	140	200	240	260	
	Available static pressure MED fan speed (Pa)	-	160	210	220	55
	Available static pressure MIN fan speed (Pa)	-	-	50	180	53